

# ALCHEMY

---



---

## SPECIFICATIONS

**Length:** 24.99 metres (82')

**Beam:** 6.30 metres (20' 8")

**Draft:** 4.29 metres (14' 1")

**Rig:** Sloop

**Number of crew:** 3

**Built:** 2009

**Builder:** Nautor's Swan

**Naval architect:** German Frers

**Flag:** Marshall Islands

**Hull construction:** GRP

**Hull configuration:**

Air conditioning

## EQUIPMENT

**Engines:** Engines: 1 x Cummins 180 HP

Engine Model: Cummins 6BTA 5.9M2

Fuel: Diesel

3 blade Brunton's folding propeller

Generators: Fischer Panda 18 NE 16 kVA generator, 230v AC, 50 Hz

Northern Lights 5000 LPE, 4.2 kVA day generator with soundshield

Mass 24/1500 VA 115v inverter for entertainment equipment

Mass 24/5000 VA, 230v inverter

Mass 24/2500 VA, 115v 60 Hz inverter for outlets

Bow thruster,

SeaRecovery 1400 GPD watermaker

**Cruising speed:** 9.4

**Fuel consumption:** 4 US Gall/Hr

## ACCOMMODATION

**Number of cabins:** 4

**Cabin configuration:** 2 Double, 2 Twin

**Bed configuration:** 1 Queen, 1 Double, 4 Single

**Number of guests:** 8

## WATER SPORTS

**Tenders + toys:** 15' Mercury 460 RIB w/ Evinrude 40 hp

Snorkel gear, water skis, wake board, inflatable ring for tender, fishing gear, 2 x paddle boards and beach games



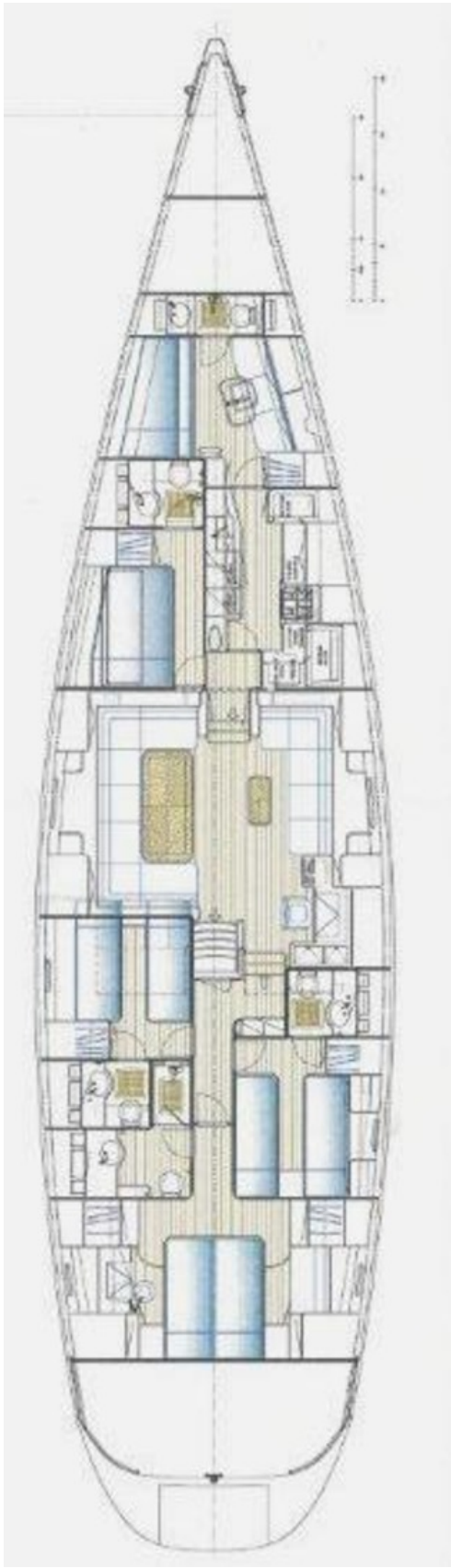



---

This document is not contractual. All specifications are given in good faith and offered for informational purposes only. The publisher and company do not warrant or assume any legal liability or responsibility for the accuracy, completeness, or usefulness of any information and/or images displayed. Yacht inventory, specifications and charter prices are subject to change without prior notice. None of the text and/or images used in this brochure may be reproduced without written consent from the publisher.